

SL210000

(2V1000Ah/10hr)

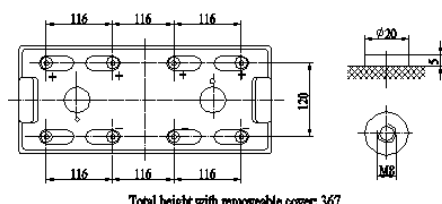
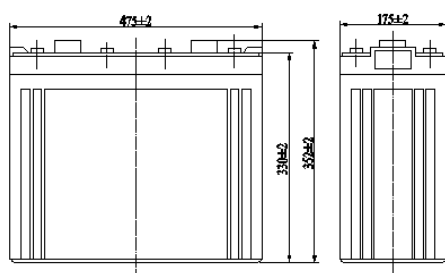

The rechargeable batteries are lead-lead dioxide systems. The dilute sulfuric acid electrolyte is absorbed by separators and plates and thus immobilized. Should the battery be accidentally overcharged producing hydrogen and oxygen, special one-way valves allow the gases to escape thus avoiding excessive pressure build-up. Otherwise, the battery is completely sealed and is, therefore, maintenance-free, leak proof and usable in any position

General Features

- Sealed and maintenance free operation.
- Non-Spillable construction design.
- ABS containers and covers(UL94HB, UL94V-0) optional.
- Safety valve installation for explosion proof .
- High quality and high reliability.
- Exceptional deep discharge recovery performance.
- Low self discharge characteristic.
- Flexibility design for multiple install positions.

Application

- Alarm System
- Cable Television
- Power tools
- Emergency Power System
- Security System
- Medical Equipment
- UPS
- Communication Equipment
- Control Equipment
- Toys

CONSTRUCTION

Component	Positive plate	Negative plate	Container	Cover	Safety valve	Terminal	Separator	Electrolyte
Raw material	Lead dioxide	Lead	ABS	ABS	Rubber	Copper	Fiberglass	Sulfuric acid

TECHNOLOGY PARAMETER

Battery model	SL210000			
Designed Floating Life	15 Years			
Capacity (25℃)	10hR(100A, 1.8V)	5hR(180A, 1.75V)		1hR(620A, 9.60V)
	1000Ah	900Ah		620Ah
Dimensions	Length	Width	Height	Total Height
	475 ±2mm	175 ±2mm	330 ±2mm	367 ±2mm
Approx. weight (±5%)	61 Kg			
Internal resistance	Full charged at 25℃: 0.3mOhms			
Self discharge	3% of capacity declined per month at 25℃ (average)			
Capacity Affected by Temp.(10HR)	40℃	25℃	0℃	-15℃
	102%	100%	85%	65%
Charge Voltage (25℃)	Cycle use		Float use	
	2.35-2.45V(-5mV/℃), max. Current: 200A		2.25-2.30V(-3.3mV/℃)	

SL210000 (2V1000Ah/10hr)

Constant current discharge ratings-amperes at 25°C

End Point Volts/Cell	15min	30min	1h	2h	3h	4h	5h	8h	10h
1.60V	1408	1063	620	351	261	220	195	130	108
1.65V	1340	1016	602	343	256	215	190	127	106
1.70V	1270	967	582	335	253	211	185	124	104
1.75V	1199	917	546	324	250	206	180	122	102
1.80V	1127	866	534	316	243	199	173	118	100

Constant power discharge ratings-watts at 25°C

End Point Volts/Cell	15min	30min	1h	2h	3h	4h	5h	8h	10h
1.60V	2421	1804	1114	720	522	421	360	245	206
1.65V	2290	1713	1067	702	507	411	354	240	202
1.70V	2158	1621	1018	688	497	404	348	236	199
1.75V	2024	1527	967	676	488	396	341	231	195
1.80V	1890	1432	915	661	476	388	335	228	192

